

Wall Switch Introduction

Terncy Wall Switch is a ZigBee endpoint accessory, that connects to Terncy Home Center ZigBee hub. It's designed to automate home lighting and perform synchronized actions of several devices to trigger a scene of life with just one click.

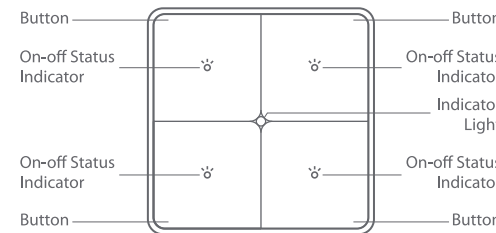

1

Indicator Light State



State	Fast flashing (10 flashes per second)	Connecting to Home Center nearby
	Slow flashing (1 flash every 2 seconds)	Successfully connected to Home Center
	Medium flashing (4 flashes per second)	Failed to connect to Home Center

2

On-off Status Indicator State

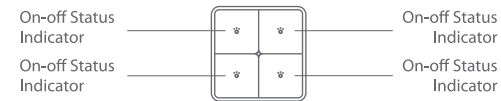

State	Lighting on	The device connected directly to it is powered on
	Lighting off	The device connected directly to it is powered off

The default function of the on-off status indicator varies with the number of the circuits(gang) supported by the Wall Switch. For instance, a 2 gang Wall Switch will have two on-off status indicators indicating the status of the devices connected directly to it, and have the other two glowed when pressed for interactive feedback.

3

Physical Installation



1. Cut down the power before wiring.
 2. Connect live wire to L-hole, and load wire to L1/L2/L3-hole of the Wall Switch.
 3. Install the Wall Switch into the junction box, and install the faceplates with the screws included in the package.
- * **This product does not support neutral wire.**
 - * **Power Supply: 100-240V, 50/60H. Min Input: 5W. Rated Current: 6A.**
 - * **The number of the circuits supported by the Wall Switch may be varied by actual product.**

4

Download and Install App

Download Terncy app from application markets or scan the QR code below. Follow the direction in the app to connect your accessory to Home Center.

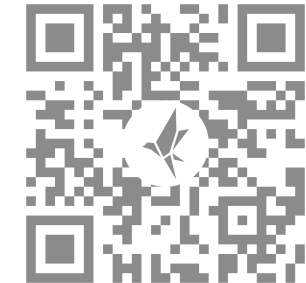

5

Setup Accessory for The First Time

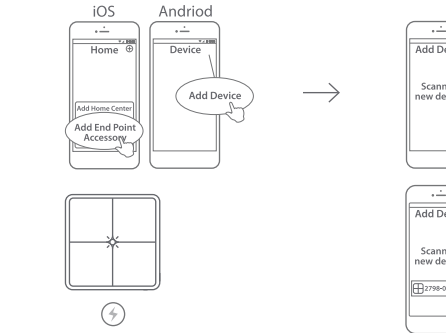

1. Navigate to "Add Device" page in the app.
2. Turn the power back on. Confirm the indicator light on the Wall Switch lights up.
3. The app will automatically detect the accessory, typically within 5 seconds.

6



WeChat official account

Contact Us

Online Support: <http://www.xiaoyan.io/service>
E-mail: support@xiaoyan.io
Manufacturer: Shanghai Xiaoyan Technology Co., Ltd.
Address: Room 503, Building B, NO.2305, Zuchongzhi Road, Shanghai, China

Setup Accessory Again

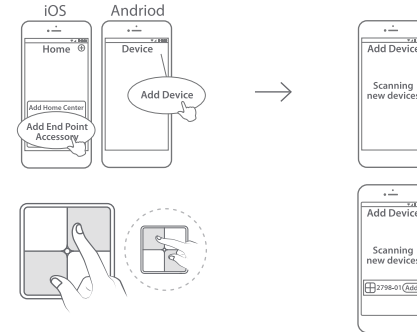

1. Navigate to "Add Device" page in the app.
2. Press the button in the upper left and the button in the lower right simultaneously for 5 seconds. The indicator light will start flashing.
3. The app will automatically detect the accessory, typically within 10 seconds.

Automation

(This function works properly with HomeKit only when meeting the requirements in Notes 2 of the latter part.)

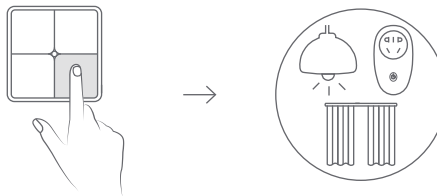

One click launches synchronized actions of several devices.

Automation

(This function works properly with HomeKit only when meeting the requirements in Notes 2 of the latter part.)

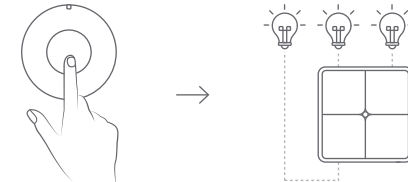

Works with another Wall Switch or Awareness Switch to act as a 2 way switch.

Automation

(This function works properly with HomeKit only when meeting the requirements in Notes 2 of the latter part.)

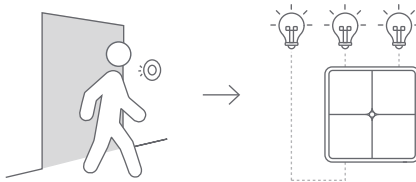

Lights will be lit up automatically when someone passes by.

Automation

(This function works properly with HomeKit only when meeting the requirements in Notes 2 of the latter part.)

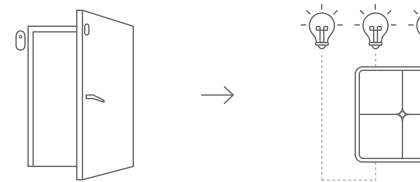

Lights will be lit up automatically when opening the door.

Notes 1

1. Do not touch the circuit board when powered on.
2. Do not soak or wash your devices.
3. Keep products away from fire, high temperature or any other extreme environment.

Notes 2

Home Center is required to enable Wall Switch to work with HomeKit technology. Visit <http://www.xiaoyan.io> for more details.



Manual of Wall Switch (without Neutral Wire)

Warranty Card

Xiaoyan's after-sales service includes:

Xiaoyan Tech shall remove any physical defects inherent in the device which are listed on the warranty card, free of charge, by replacing (at the sole discretion of Xiaoyan Tech) the defective device within the period of 15 days from the date of reception by the consumer, and by repairing the defective components of the device within the period of 12 months from the date of reception by the consumer.

*** The warranties may be varied in different countries and regions.**

The Warranty Applies to:

1. surface damages resulting from mishandling during transport or defects inherent in material or structure of the products;
2. failure of the buttons or indicator lights;
3. failure of wireless communication.

The Warranty Does Not Apply:

1. when the warranty period expired;
2. to damages resulting from repairing and introducing alterations by unauthorized persons;
3. to damages caused by using accessories not recommended by the manufacturer;
4. to damages resulting from other irresistible causes.